

BeamOn U3 Basic

Innovative Beam Profiler (1/1.2")



40 Hz

High resolution
(2.35 MPixel)
12 bit dynamic
range

USB 3.0

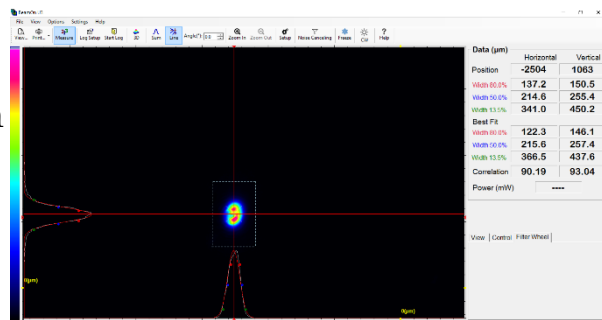

Versatile – Measures Profile, Power, Position & Multiple Beams in Parallel

Specifications

Spectral Response	350 – 1600 nm (VIS NIR)	Resolution (H x V pixels)	1920 x 1200
Sensor Active Area (mm)	11.34 x 7.13, sensor can be divided into multiple active areas, working in parallel for up to 400 sectors (NEW)	Pixel Size	5.86 µm x 5.86 µm
Gain Control	1 -24 dB	Frame Rate	40 fps – up to 550 fps @ fast mode (NEW)
Dynamic Range	60 dB not including filters	Interface	USB 3.0, windows 7/8/10 (32 & 64 bit)
Shutter Speed	39 µsec to 20 sec	Min. Hardware Requirements	CPU i3 1.6 GHz, 4 GB RAM
Beam Size	Down to 75 microns, @ min. beam size- power restrictions	Pixel Bit Depth	12 bits
Accessories (optional)	-IR Edge Filter -SAM3-C -RDC -C-Mount Filter (ND8/ND200/ND1000)	Synchronization	•Software •Hardware (external trigger signal)
		Exposure Control	Programmable via GUI
		Housing Size (L x W x H) in mm	64 x 46 x 73.5
		Power Requirements	~2 Watt (Via USB 3.0 interface)
		Weight (typical)	250 gr.
		Mechanical Interface	Post mounting: 2 concentric opposite 8-32 UNC 6 mm depth at the detector plane Optical attachments & filters: C-mount

Wavelength	633	980	1310	1550
Saturation	20 µW/mm ²	100 µW/mm ²	0.2 W/mm ²	2 W/mm ²
Sensitivity	Better than 1 nanoW/mm ²	Better than 1 nanoW/mm ²	200 µW/mm ²	2 mW/mm ²

Ordering Information

Model BeamOn U3-VIS NIR-

Basic: A camera for 350 – 1600 nm, USB3.0 cable, application software on CD/Disk on key.

SAM3-C: Attachment for high power lasers attenuation (up to 20 W)

IR-Edge Filter: C-mount filter for IR Edge.

RDC: Attachment for beam reducer (ratio 2x1)

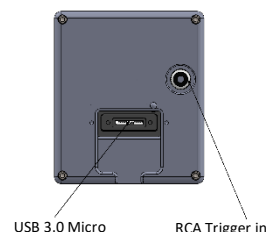
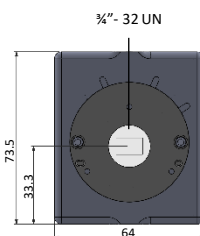
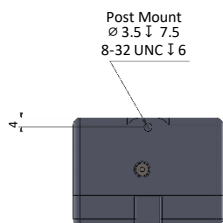

Dimensions are in mm.

DUMA OPTRONICS LTD.

Website: <http://www.dumaoptronics.com>

E-mail: sales@duma.co.il

November 2020